

effective, sterile and safe eyewashes for industrial use

CHEMICALS IN THE EYE CAN CAUSE SERIOUS DAMAGE WITHIN SECONDS. WASHING WITHIN A FEW SECONDS CAN BE DECISIVE IN MINIMISING EYE DAMAGE.

A temporarily blinded person trying to reach an eyewash a few metres away requires presence of mind, a good sense of direction and an obstacle free passage. In all potentially hazardous environments **an eyewash solution should be within arms reach.**

Ideal for applications where plumbed eyewash systems are not practical.

Tobin Eyewashes have been proven to be a quick and safe way to wash chemicals and irritants from the eyes. This **specially designed system gives the fastest possible application** combined with a volume large enough to remove most eye contaminants.

One Tobin Eyewash 1 litre bottle gives approximately 3 minutes of washing,

a five bottle stand can deliver 15 minutes of washing if required.

Auxiliary bottles can easily be removed from the stand and **taken along during patient transportation** to a doctor.



Tobin's bottle is constructed to empty under natural pressure giving a soft flow

a one litre bottle provides approximately 3 minutes continuous flow

3 year shelf life, expiry date is clearly marked on each bottle

the correct flow releases when the bottom air vent is open, for eye safety squeezing the bottle will not increase flow

the eye is washed by a soft flow consisting of 6 tiny streams.

WALL STAND - 2 OR 5 BOTTLE

- Wall stands for stationary work places or transport stand for mobile units
- Sterile saline solution to rapidly remove most eye contaminants
- Specially designed bottles with opened air vent give 3 minutes of continuous flow
- 1 litre sterile saline bottles with 3 year shelf life from time of manufacture



Order Code: **TOB129 - 2 bottle stand** 39(H) x 20(W) x 10(D) cm

TOB124 - 5 bottle stand 39(H) x 45(W) x 10(D) cm

TRANSPORT STAND

- For mobile units i.e. trucks, boats, trains etc
- 3 Year Shelf life
- Weight: 2.9kg
- Dimensions: 34(H) x 20(W) x 10(D) cm

Order Code: **TOB127**

**POCKET EYE WASH BOTTLE**

- Personally carry in pocket
- Enables washing in seconds
- Contains 200ml sterile saline solution
- 3 year shelf life

Order Code: **TOB121**

**REPLACEMENT BOTTLES - 1LITRE**

- Bottle hangs by its cap
- To open simply break off the cap
- Flow can be stopped, to allow blinking & eye movements
- Each bottle shows recommended expiry date



Order Code: **TOB126** 2 x 1 litre bottles
TOB128 5 x 1 litre bottles

EYE WASH CABINET

- Includes 2 x 1 litre bottles, cabinet and screws
- Keeps eyewash bottles protected in tough environments
- Dimensions: 35(H) x 25(W) x 10(D) cm

Order Code: **TOB130**

**TOBIN TRANSPORT EYEWASH BOTTLE**

- 500ml sterile saline solution
- 3 year shelf life
- Enables immediate flushing of eyes
- Can be located within arms reach for a quicker response time
- Great option for transport vehicles with dangerous goods cargo
- Ideal where primary emergency shower and eye wash equipment is not required
- Dimensions: 27 H x 8 W x 8 D cm

Order Code: **TOB500**
TOB500ST with stand

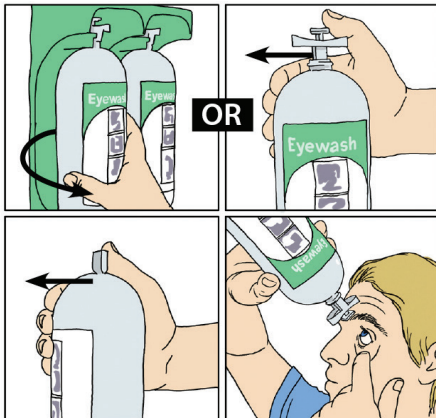
**SIMPLE TO USE EFFECTIVE STERILE EYEWASH FOR INDUSTRIAL USE**

- Break eye wash outlet
- Open air vent at the base of the bottle
- Hold eye lid open
- Hold bottle above eye
- 3 minutes of continual flow per bottle

Bottles are supplementary support and do not remove the need for primary Eyewash Stations as where required by AS4775 and ANSI Z358.1